

PRODUCT SPECIFICATION SHEET

| Product                 | UN Mark |
|-------------------------|---------|
| EZ2500 25ltr T/E Bucket | N/A     |
|                         |         |
|                         |         |

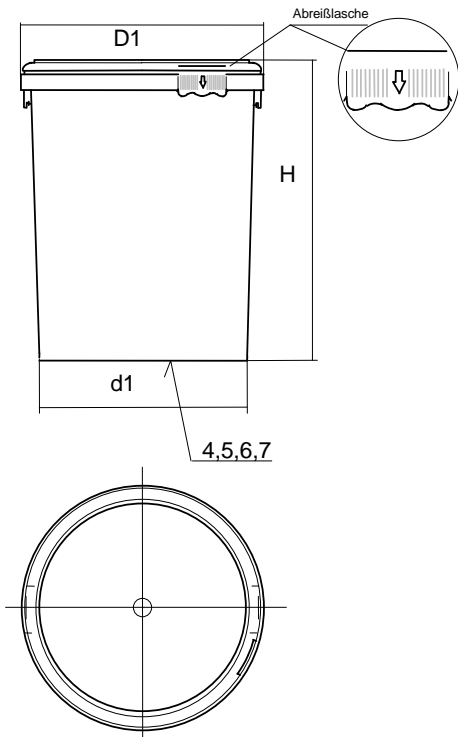

| Bucket            |                                       |
|-------------------|---------------------------------------|
| Material          | Polypropylene Copolymer food approved |
| Fabrication       | Injection moulded                     |
| Handle            | Metal                                 |
| Nominal Capacity  | 25ltr                                 |
| Brimful Capacity  | 27.7ltr                               |
| Nominal Weight    | 670g +/-18                            |
| Pallet Quantity   | 192                                   |
| Pallet Size       | 1200x800x2170mm                       |
| Weight per Pallet | 217kg                                 |
| Stock Colours     | White                                 |

| Dimensions         | mm  | Lid - DZ2000   |                                       |
|--------------------|-----|----------------|---------------------------------------|
| Height             | 417 | Material       | Polypropylene Copolymer food approved |
| Top Diameter 'D1'  | 337 | Fabrication    | Injection moulded                     |
| Base Diameter 'd1' | 278 | Height         | 16mm +/-1%                            |
|                    |     | External Dia   | 336 +/-1%                             |
|                    |     | Nominal Weight | 158g +/-10                            |
|                    |     | Pack Size      | 48 per bag                            |
|                    |     | Stock Colours  | White Green Red T/E and Blue NON T/E  |

| Additional Information  |
|---|
| 4 pallet minimum order for coloured buckets<br>Printing available please contact us for a quotation |

| PPREF | Issue | Date of Issue | Approved By |
|-------|-------|---------------|-------------|
| AT    | A     | 27.01.07      | Roy Miller  |

**UNCONTROLLED COPY**